

SWIFT TRAWLER 41

KEY SELLING POINTS



BENETEAU
AVANT-GARDE IN BOATING



BENETEAU

Unique Selling Points

- Two versions : Fly & Sedan → NEW in the Swift Trawler range
- U-shaped galley at the aft wheelhouse
- 7 berths
- 2 choices of engine : 2 x 270 CV or 2 x 300 CV
- DNA Swift Trawler

Specifications



2 x Volvo D4-270cv
2 x Volvo D4-300cv

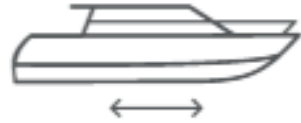

13,43 m



4,25 m



7 people
2 cabins
2 bathrooms



10 520 kg light (Sedan)
11 040 kg light (Fly)



1200 L



400 L



B 8/ C 10 / D10

Performance



Volvo – Shaft drive

2 x 270 CV / 380 KW
2 x 300CV / 440 KW



Speed Max

22 kts – 2x260 CV Sedan
23,5 kts – 2x300CV Flybride



Autonomy

186nm (@14,6kts) – 2x260cv
180nm (@16kts) – 2x300cv

KEY SELLING POINTS

EXTERIOR

SEDAN VERSION



FLYBRIDGE VERSION



SEDAN VERSION

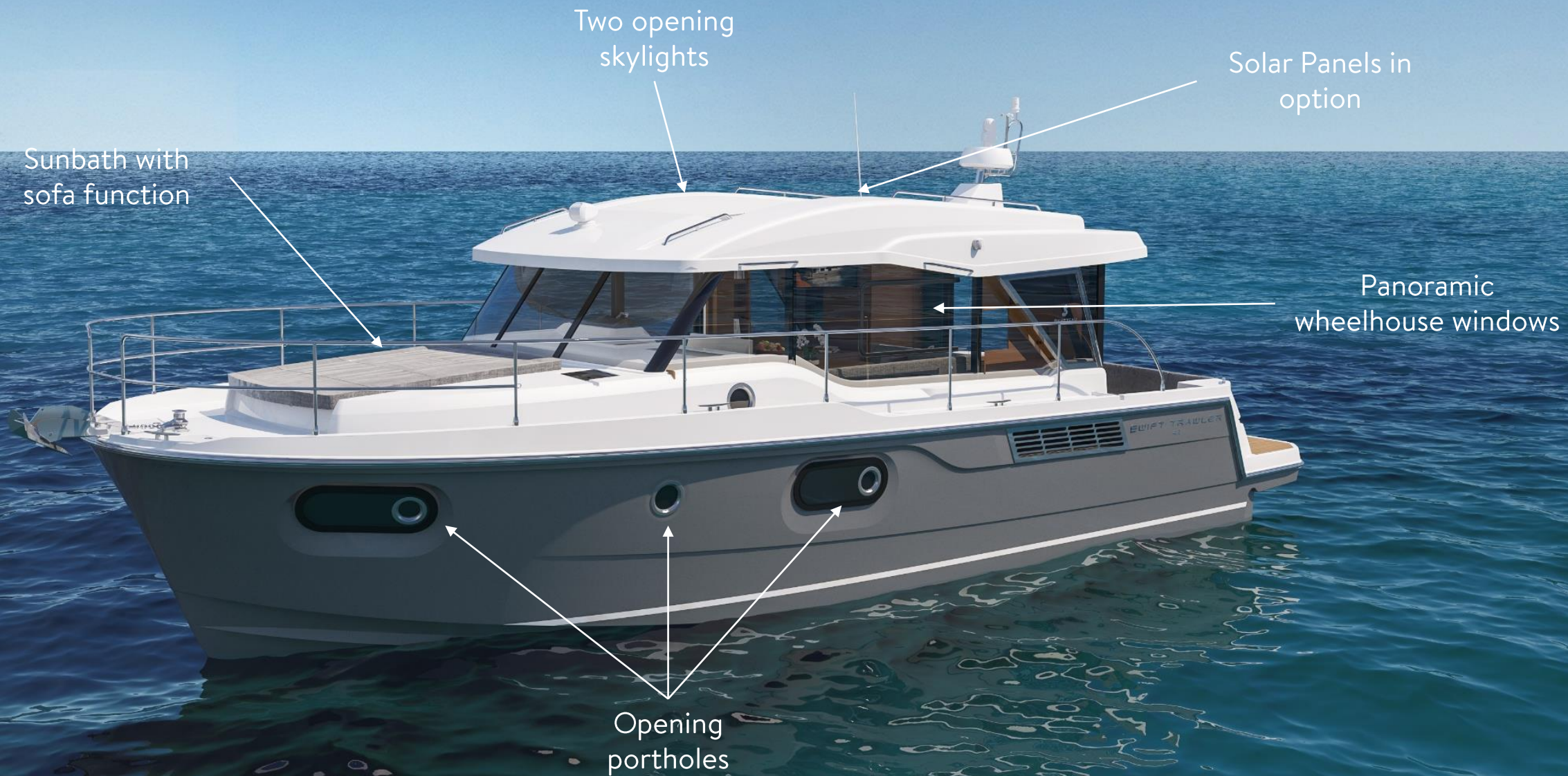

SEDAN VERSION

Optional solar panels

Sliding bench seat

Bulwark gate

Wheelhouse door

Sidedeck door

Safe & ergonomic swim stairs

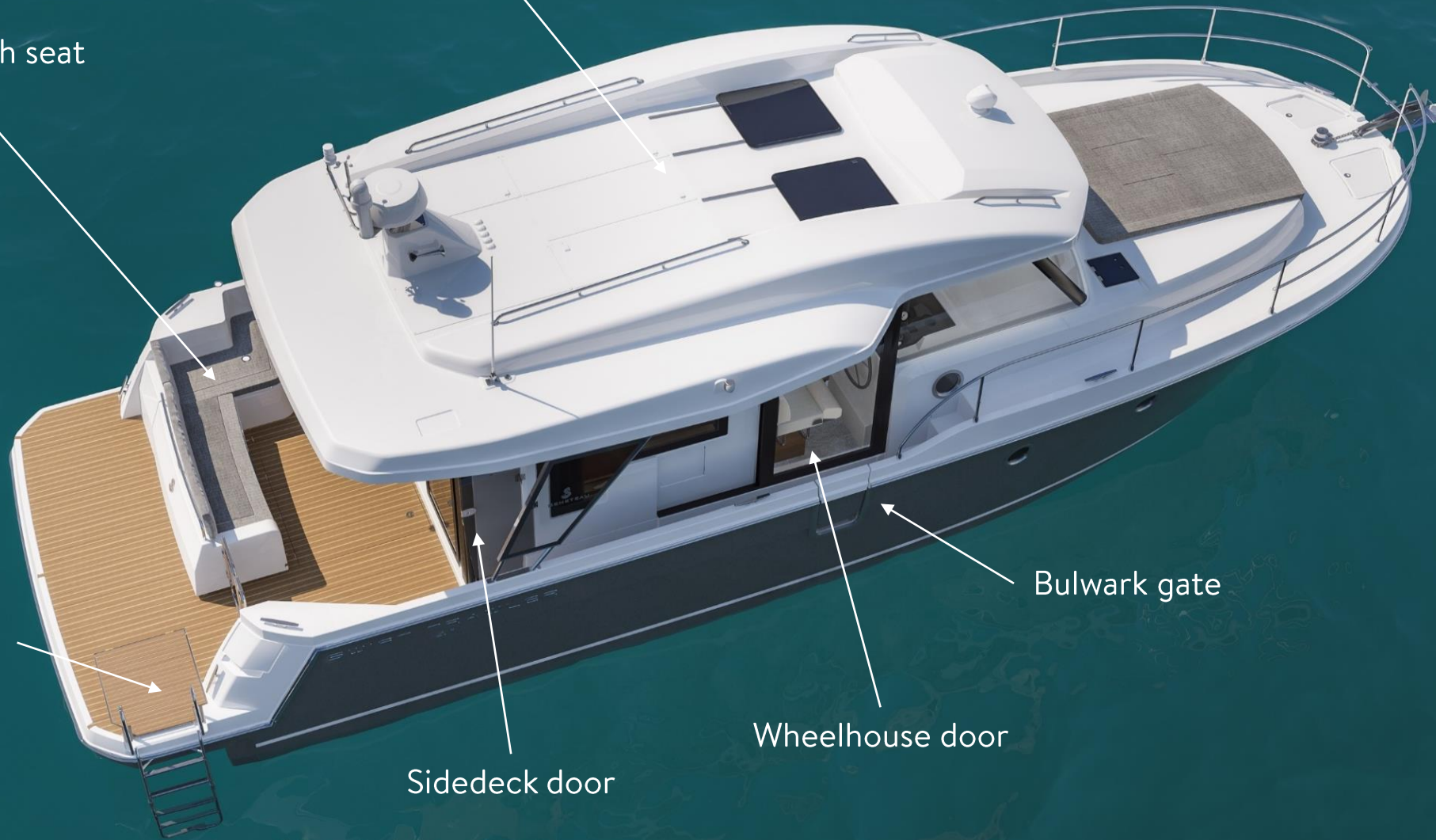

FLYBRIDGE VERSION

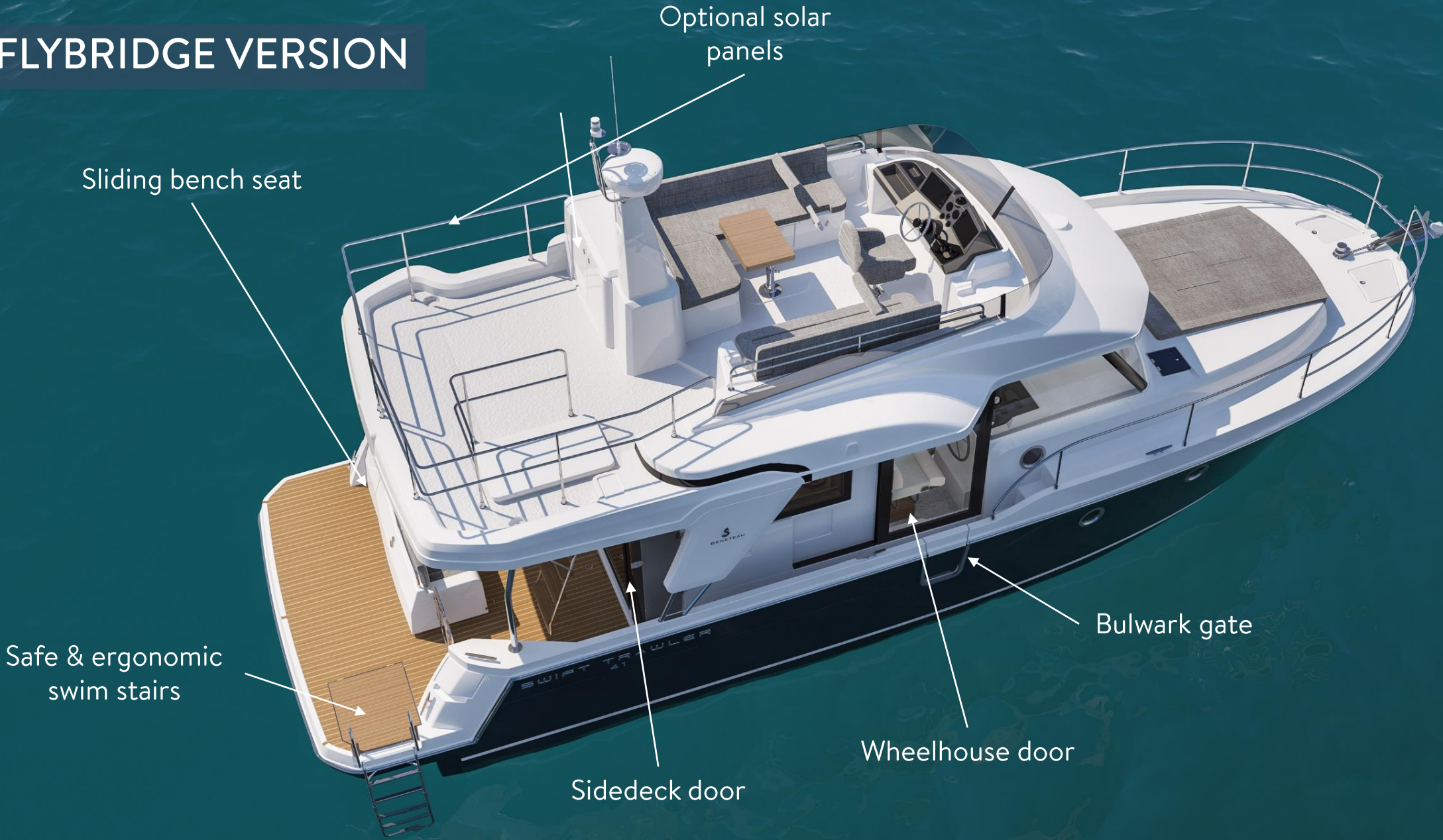

Optional solar panels

Sliding bench seat

Safe & ergonomic swim stairs

Sidedeck door

Wheelhouse door

Bulwark gate

Flybridge Version

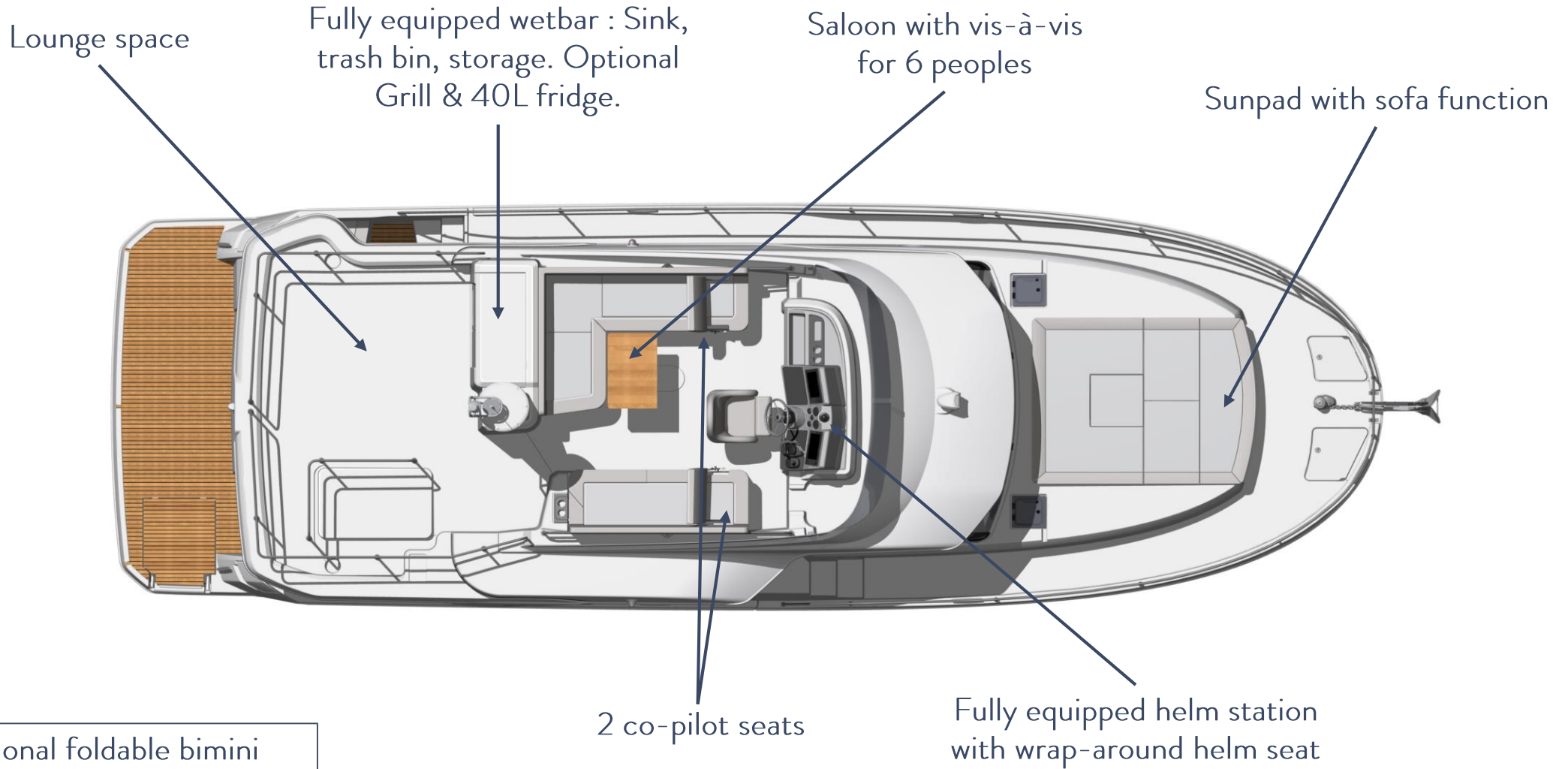

- Optional foldable bimini
- Optional solar panel

The background is a solid blue color with several large, overlapping, semi-transparent curved shapes in a lighter shade of blue, creating a modern, abstract design.

KEY SELLING POINTS

MAINDECK

New layout for Swift trawler range

Sliding bench seat
creating extended
cockpit

U-shaped at the aft
wheelhouse

Convertible Sofa

Saloon for 6 person

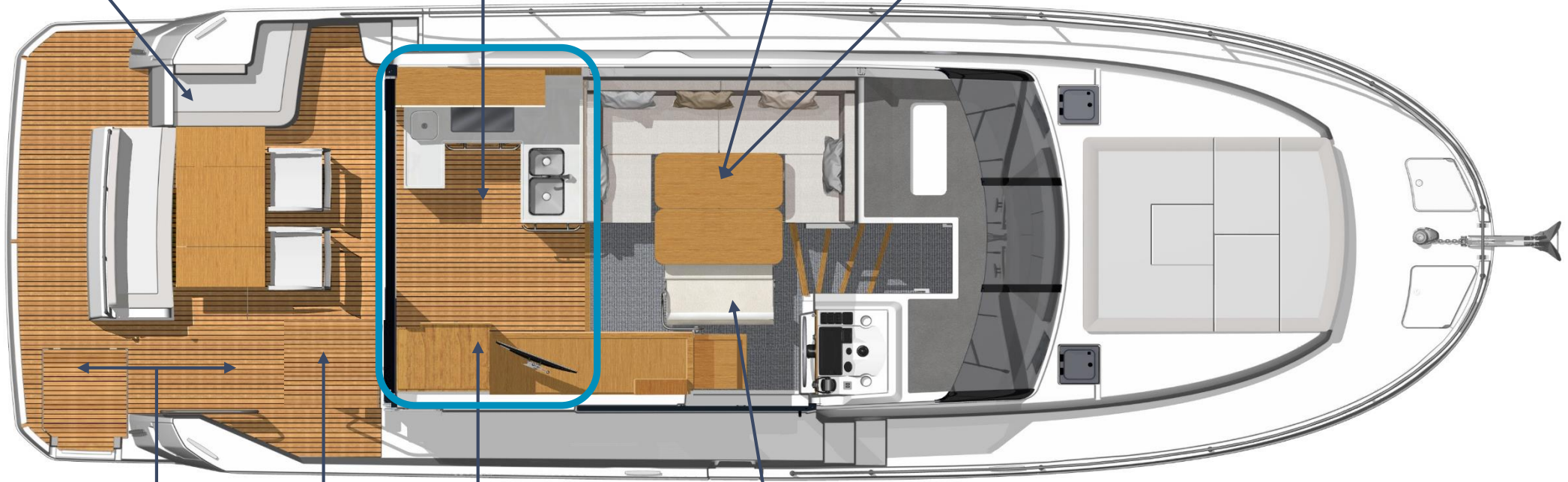

Level floor between
platform and cockpit

Generous storage
and Fridge/freezer
column (total 215L)

Rotary pilot seat
with handrail

Retractable fly stairs



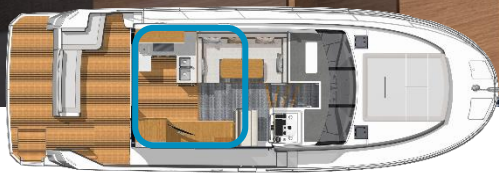





Option rotary seat with handrails

TV emplacement

215 L Fridge/Freezer column

3 Storages

Extended table

Saloon convertible in bed

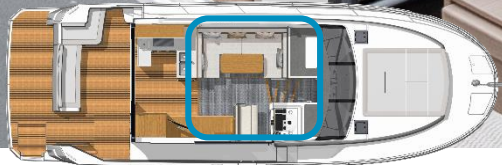



Option rotary seat with handrails

TV emplacement

215 L Fridge/Freezer column

3 Storages

Extended table

Saloon convertible in bed

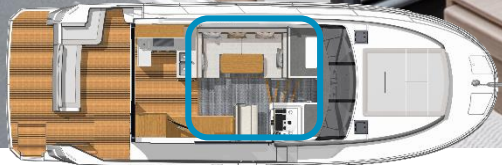

The background is a solid blue color with several large, overlapping, curved shapes in a lighter shade of blue, creating a sense of movement and depth. The shapes are primarily located in the top-left and bottom-right corners.

KEY SELLING POINTS

LOWERDECK

VIP cabin

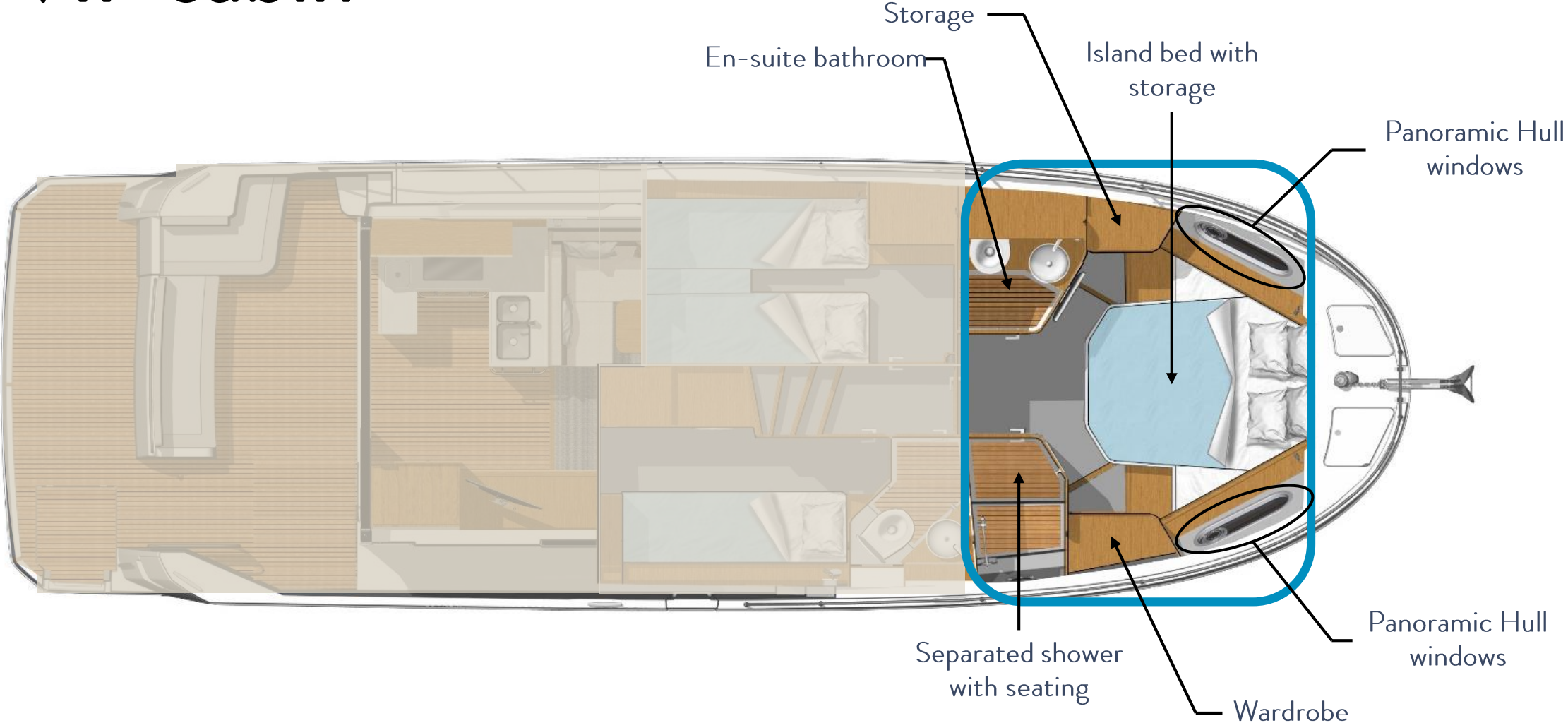

VIP CABIN

Opening
Skylight

Separate
shower

En-suite
bathroom



VIP CABIN

Large hull windows with inset portlights

Wardrobe

Shelves

Storage under the bed



En-suite bathroom



Private separated shower

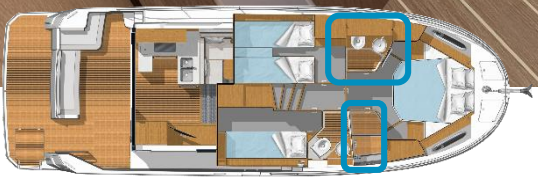

GUEST CABIN

Manual Opening window

Panoramic view at sea

Wardrobe

Twins beds convertible in double bed

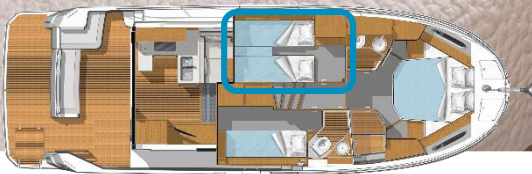

GUEST BATHROOM



LAZARETTE

Optional Washer dryer

Storage

Optional space for an additional berth

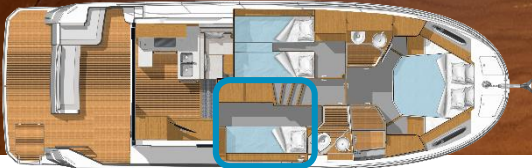

The background is a solid blue color with several large, overlapping, curved shapes in a lighter shade of blue, creating a sense of movement and depth. The shapes are primarily located in the top-left and bottom-right corners, framing the central text.

KEY SELLING POINTS

AMBIANCE

Alpi teak wood

▶ Interior woodwork



Alpi teak wood



▶ Interior upholstery

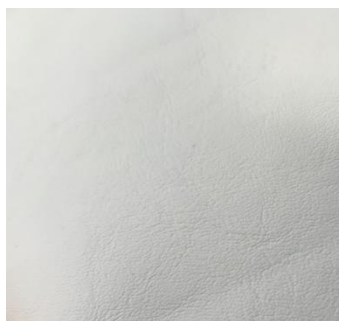

*PVC Marlin Brilliant
White (std)*



Gargoyle



Greige

▶ Flooring



Teak with striped



Brown oak

▶ Design option door



*Furniture top
"Ivory"*



Slatted door

Alpi Oak wood

▶ Interior woodwork



Alpi Oak



▶ Interior upholstery

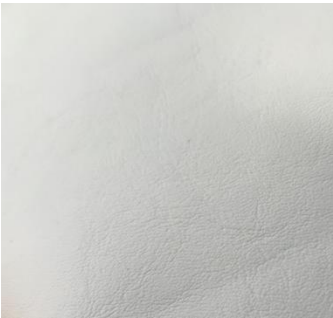

*PVC Marlin Brilliant
White (std)*



Gargoyle



Greige

▶ Flooring



Teak with striped



Brown oak

▶ Design option door



*Furniture top
"Ivory"*



Slatted door

Interior upholstery

▶ Materials



*PVC Marlin Brilliant
White (std)*



Gargoyle



Greige

▶ Foglizzo Leathers

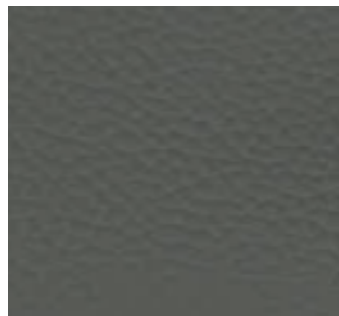

Hot grey - DK17

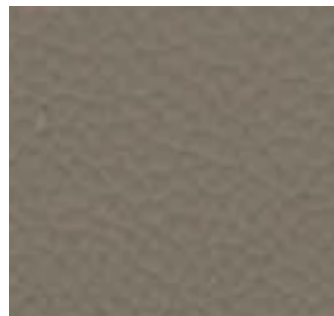

Taupe - DK45



DK15

▶ Foglizzo Nubuck



Chocolate - LG13

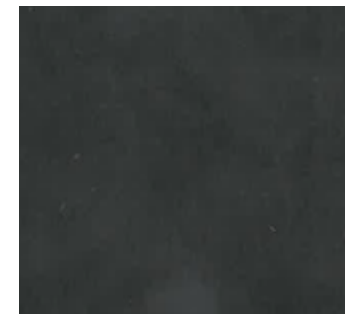

Petrol - LG10





BENETEAU
AVANT-GARDE IN BOATING